

# Current Transducer/Sensor

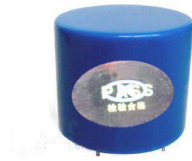



## BJ29 Pulsating DC Current Isolation Transducer

Pulsating DC products refers to the input signal by the current or voltage signal of the rectification is not filter or the ripple content > 10%.

### FEATURES

- \***Working principle:** Linear photoelectric isolating
- \***Advantage:** The best performance/price ratio, fast response, high accuracy, good stability, small volume, light weight, easy installation, and measure the DC voltage input
- \***Application:** Measure large DC signal ripple site
- \***Dimension (mm):** BJ29: 23(L) × 33(W) × 40(H)

### MODEL

LF-PDI12-  BJ29-0.5/  
A B C

Model selection1:LF- PDI12-32 BJ29-0.5/10mA

Explanation: this product is a 10mA input range, 5V output, 12V power supply, BJ2- style Pulsating DC Current Transducer

### DIMENSION DIAGRAM

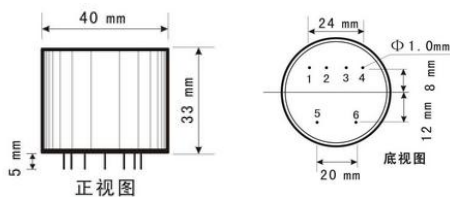

### ELECTRICAL DATA

- \*Input Range: 1mA~1500mA can choose 10mA, 100mA etc
- \*Accuracy Grade:  $\leq 0.5\%$ .F.S
- \*Linearity Degree: better than 0.1%
- \*Response Time: Photoelectric isolation < 15 us;  
Modulation type < 150 ms.
- \*Offset Voltage:  $\leq 10$ mV
- \*Frequency Range: 20~5 KHz
- \*Temperature Characteristics: $\leq 100$ PPM/°C(0~50°C)
- \*Power Consumption:  $\leq 25$  mA
- \*Load: Voltage output: 5mA, Current output: 6V
- \*Over Load: 2 times of input
- \*Isolation Withstanding Voltage:  
AC3.0KV/min\*1mA between input /output/ power
- \*Flame Redundancy: UL94-V0
- \*Working Environment:-10°C~70,  
20%~90% without condensation
- \*Storage Environment:-40°C~85,  
-20%~95% without condensation

### MODEL REMARKS

A---Output	B---Power supply
1. 0~10V	1. 5V
3. 0~5V	2:12V $\pm 10\%$
4. 0~20mA	4:24V $\pm 15\%$
5. 4~20mA	
T: Special output	C---Current input range

### CONNECTION DIAGRAM

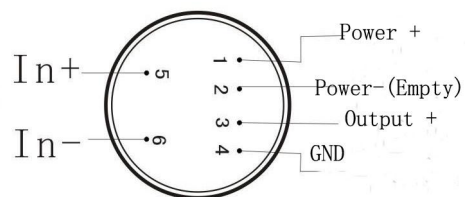

Xiamen ZT Technology Co., Limited